

Former Marble Quarry Landfill
109 Marbledale Road
Tuckahoe, New York

NYSDEC Brownfield Cleanup Program #C360143

Community Meeting #7

February 22, 2017



HydroEnvironmental
SOLUTIONS, INC.

One Deans Bridge Road Somers, New York 10589
(914) 276 - 2560 Fax: (914) 276 - 2664

Source Area 2 Removal

- First source area removed was SA-2 (located within the hotel footprint).
 - Source Area 2 was approximately 20-feet wide, 36-feet long and 15-feet deep for a total volume of approximately 400 cubic yards removed.
- Removed soils went to Bayshore Recycling, located in Keasbey, New Jersey.
- CAMP monitoring was in place during all invasive earth moving activities on-site.
- In accordance with the approved RAWP, excavation end-point soil samples were collected and analyzed for VOCs, SVOCs, PCBs, TAL Metals and pesticides. (Results Pending)

Source Area 2 Removal (continued)

- End-point soil results were taken from the bottom and the side-walls of the excavation footprint and compared to the Commercial soil cleanup objectives (CSCOs).
- If end-point soil sampling results do not meet CSCOs, additional excavation may be required and warranted; however, it is assumed that excavation completion depths will not exceed 15 feet below grade.
- The excavation was secured using fencing and covered in polyethylene sheeting for odor and dust suppression purposes.

Source Area 2 Removal (continued)



Source Area 2 Removal (continued)



Remaining Source Areas

- A comprehensive Scope of Work has been submitted and approved for Source Areas 1, 3 through 10 removal.
- The procedures outlined for SA-2 will be followed for all source area removals.
- Began SA-3 removal on February 17, 2017.
 - Uncovered antiperspirant sprays and cremes.
 - Sprays and cremes separated from soil and containerized in a covered roll-off for future disposal.

Remaining Source Areas – SA-3



Remaining Source Areas – SA-3



Remaining Source Areas – SA-3



Supplemental Environmental Work Technical Report to be Completed

Supplemental Environmental Investigation (EI) Report was submitted on February 21, 2017 as a draft to the NYSDEC and the Village for review.

Supplemental EI Report Includes:

- Summary Data Tables for soil, groundwater and soil vapor.
- Groundwater Elevation Contour Maps for shallow overburden and bedrock aquifers.
- Geologic Logs, monitor well and SVE well construction details.
- Summary of collected field parameters including PID and FID readings, groundwater field chemistry and CAMP air monitoring results.
- Collected data was interpreted and used to further define Source Area removal and assist in the design of the site wide cap.

Soil Vapor Extraction System Design and Report

The SVE Design Report is being compiled and will be submitted to the NYSDEC and the Village for final review and approval.

- SVE pilot testing data including air flow volume, velocity, induced vacuum and VOC air quality data will be used to design an appropriate soil vapor extraction system for the site.
- The SVE Design Report will include air quality summary tables, collected field data summary tables (ex. Induced Vacuum), radius of influence maps and iso-concentration maps.

Proposed Future Construction Work – Order of Operations

1. Data compilation and review to determine if any modifications to the Work Plan are necessary regarding excavation and soil moving/CAMP. NYSDEC and HDR review of foundation plan and to confirm Resolution is being followed.
2. Foundation and Geotechnical Assessment – Carlin Simpson Geotechnical Engineer has replaced dynamic compaction concept.
3. Clear and Prepare Site.
4. Excavate and Dispose of Source Material Areas at off-site Disposal Facility.
5. Install Site Utilities, Stormwater Retention Systems and SVE System(s). Design SVE/SSDS, review and approval of same by NYSDEC.
6. Implement Site-Wide Cut and Fill Plan.
7. Install Building Foundations – Hotel and Restaurant.
8. Second round of groundwater sampling (following installation of foundation piles).
9. Install Vegetative and Engineered Site Wide Caps.
10. Third round of groundwater sampling (following completion of site wide caps).

Proposed Future Site Development

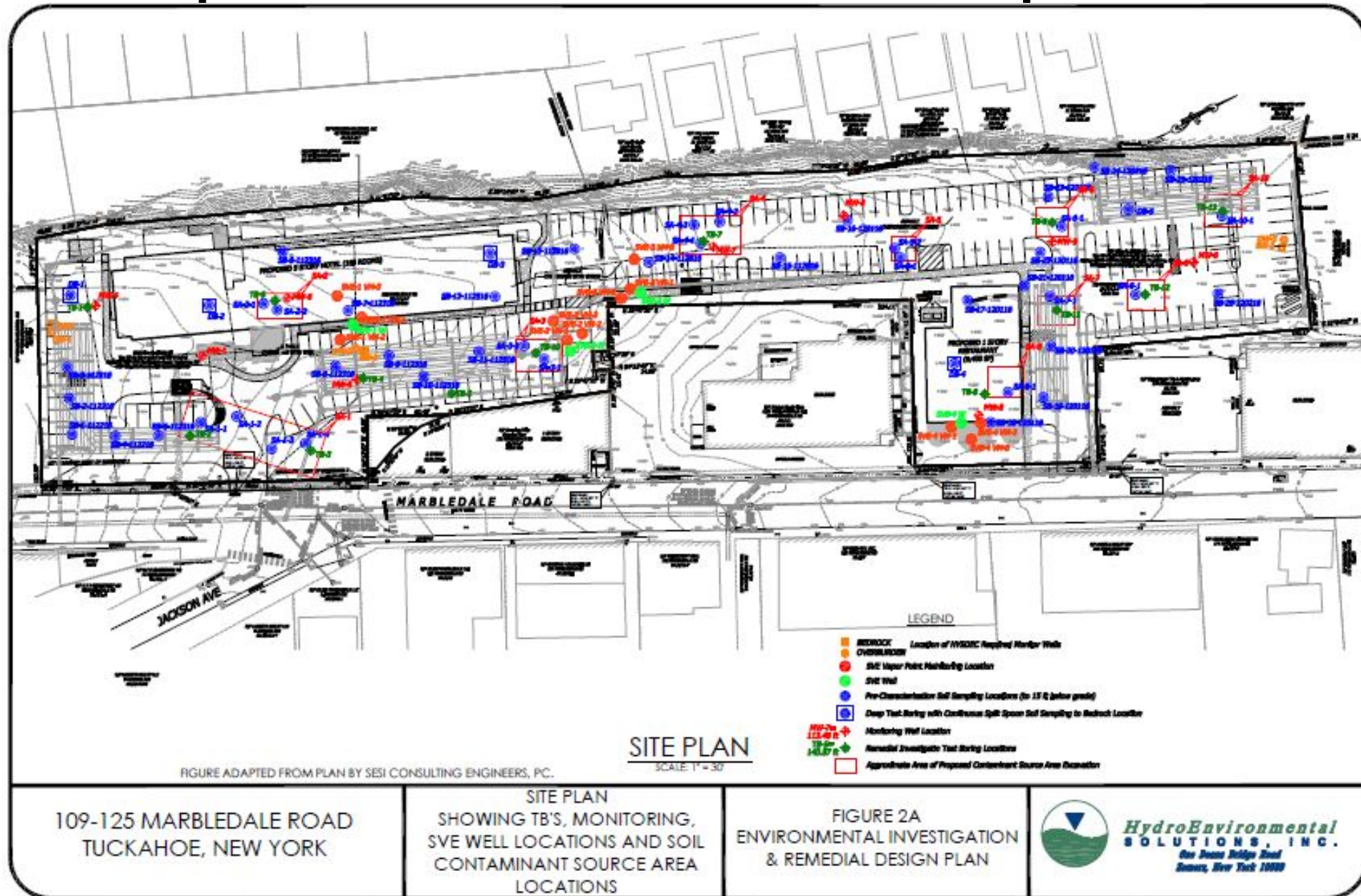

Thank You for Attending the Tuckahoe
Community Meeting Related to the
Marbledale BCP Site!

Questions?

