

**Former Marble Quarry Landfill  
109 Marbledale Road  
Tuckahoe, New York**

**NYSDEC Brownfield Cleanup Program #C360143**

**Community Meeting #8**

**March 8, 2017**



***HydroEnvironmental***  
**SOLUTIONS, INC.**

One Deans Bridge Road  
(914) 276 - 2560

Somers, New York 10589  
Fax: (914) 276 - 2664

# Source Area Removals

- As of March 8, 2017, Source Areas 2, 3, 6, 7, 8, 9 and 10 have been removed and backfilled.
- Removed soils went to Bayshore Recycling located in Keasbey, New Jersey.
- CAMP monitoring was in place during all invasive earth moving activities on-site.
- In accordance with the approved RAWP, excavation end-point soil samples were collected and analyzed for VOCs, SVOCs, PCBs, TAL Metals and pesticides.

# Source Area Removals (continued)

- End-point soil samples were taken from the bottom and the sidewalls of the excavation footprint and the results were compared to the Commercial soil cleanup objectives (CSCOs).
- If end-point soil sampling results do not meet CSCOs, additional excavation may be required and warranted; however, it is assumed that excavation completion depths will not exceed 15 feet below grade.
- The excavations were secured using fencing and covered in polyethylene sheeting for odor and dust suppression purposes.

# Remaining Source Areas

- As of March 8, 2017, Source Area 1 and 4 still need to be removed and sampled.
  - Source Area 5 will not be removed based on a review of all soil pre-characterization data (No exceedances of CSCOs).
- Additional areas to be removed include:
  - Soils around SB-1, SB-2, SB-4 and SB-5 (Lead)
  - Soils around SB-11 (Benzo(a)pyrene)



# Remaining Source Areas (continued)

- On March 6, 2017, two (2) approximately 2,000-gallon USTs were found in the northern section of SA-1 (SA-1B).
  - The liquid from the tanks will be removed via vacuum truck and the USTs will be removed by a licensed tank specialist and in accordance with NYSDEC and DOH regulations.

# Remaining Source Areas

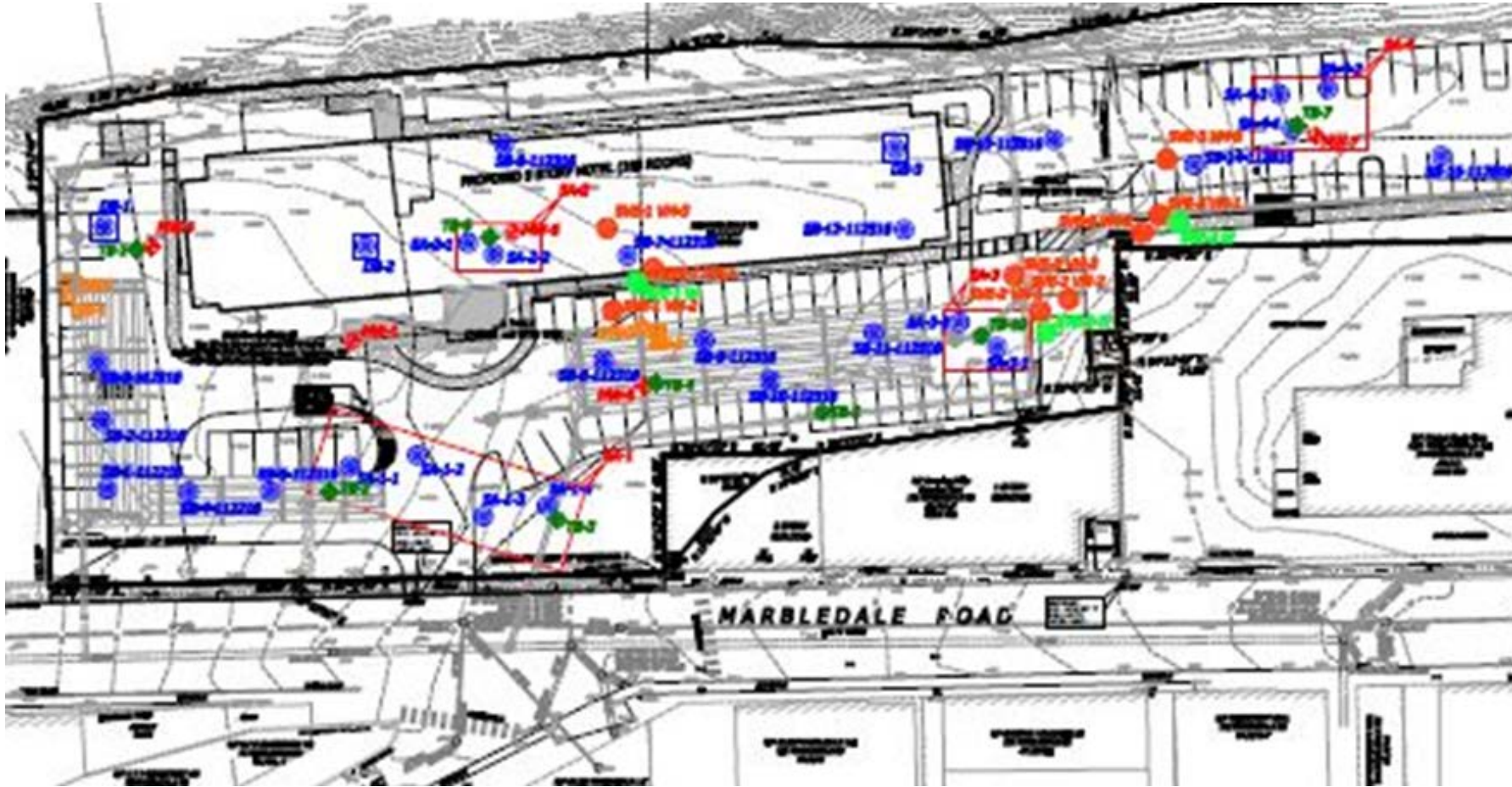



# Source Area 1 Removal





# Source Area 1 Removal





# Source Area 1 Removal





# Source Area 1 Removal





# Source Area 1 Removal





# Source Area 2 Removal





# Source Area 2 Removal





# Source Area 3 Removal





# Source Area 3 Removal





# Source Area 3 Removal





# Source Area 6 Removal





# Source Area 7 Removal





# Source Area 7 Removal





# Source Area 8 Removal





# Source Area 9 Removal





# Source Area 9 Removal





# Source Area 10 Removal





# Supplemental Environmental Work Technical Report to be Completed

Supplemental Environmental Investigation (EI) Report was submitted on February 21, 2017 as a draft to the NYSDEC and the Village for review.

Supplemental EI Report Includes:

- Summary Data Tables for soil, groundwater and soil vapor.
- Groundwater Elevation Contour Maps for shallow overburden and bedrock aquifers.
- Geologic Logs, monitor well and SVE well construction details.
- Summary of collected field parameters including PID and FID readings, groundwater field chemistry and CAMP air monitoring results.
- Collected data was interpreted and used to further define Source Area removal and assist in the design of the site wide cap.

# Soil Vapor Extraction System Design and Report

The SVE Design Report is being compiled and will be submitted to the NYSDEC and the Village for final review and approval.

- SVE pilot testing data including air flow volume, velocity, induced vacuum and VOC air quality data will be used to design an appropriate soil vapor extraction system for the site.
- The SVE Design Report will include air quality summary tables, collected field data summary tables (ex. Induced Vacuum), radius of influence maps and iso-concentration maps.

# Proposed Future Site Development

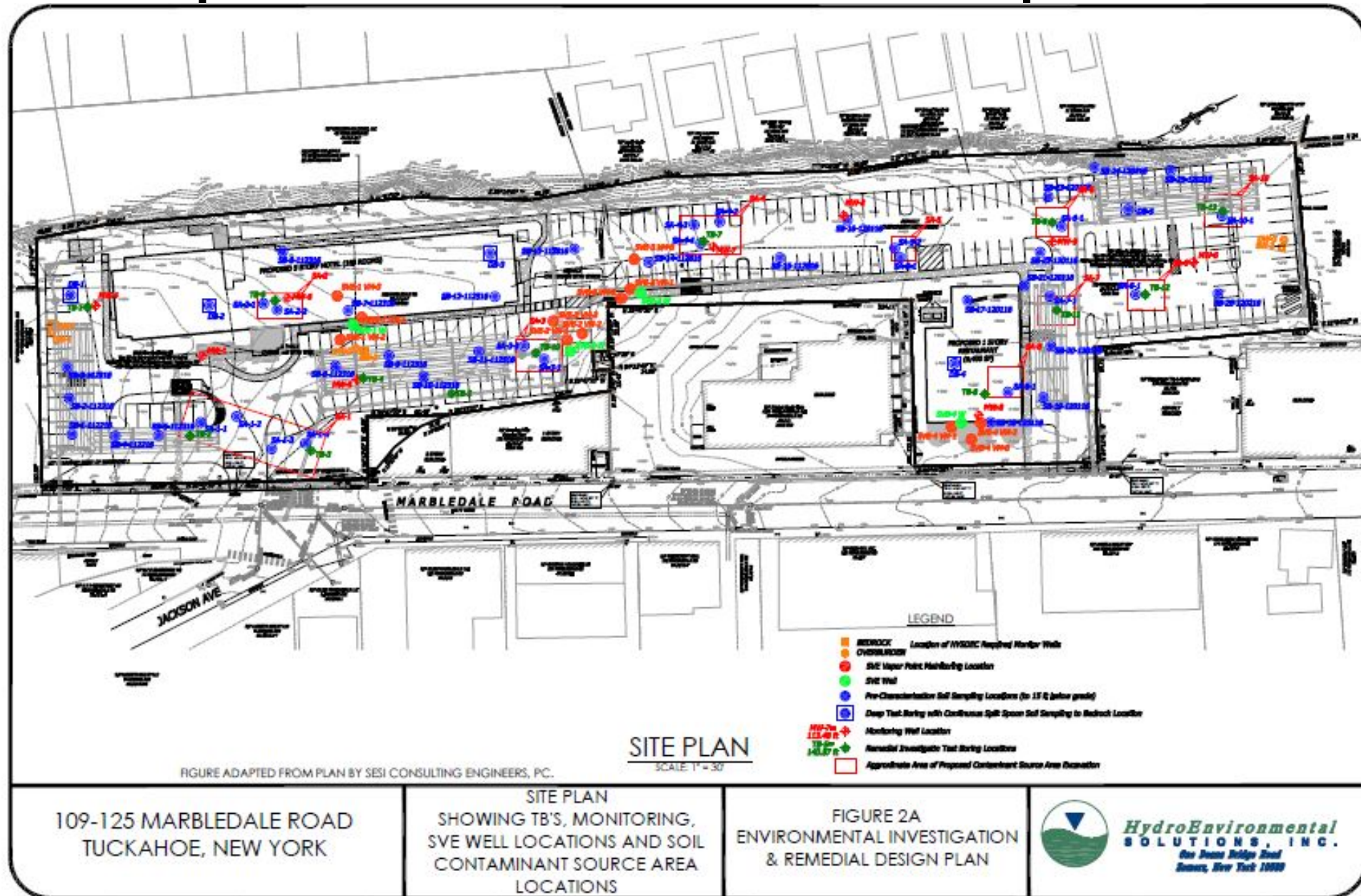

Thank You for Attending the Tuckahoe  
Community Meeting Related to the  
Marbledale BCP Site!

*Questions?*

